

MG16129-C

5LED AUXILIARY CLIP MAGNIFIER AC/DC INTERCHANGEABLE

SIZE: 2.5x90mm 7.5x34mm 10x34mm

- It is a kind of useful auxiliary tool to workers in welding or modelling field.
- Support clamp is adjustable.
- Base surface is padded with steel sheet to increase base weight and reinforce stability.
- With interchangeable magnification, two auxiliary lens are stretchable to make work easier.
- It is a very ideal tool when the third hand is required.
- Five LED lights installed on flexible metal tube have high brightness, with convenience and flexibility. They can irradiate at any position of working objects.

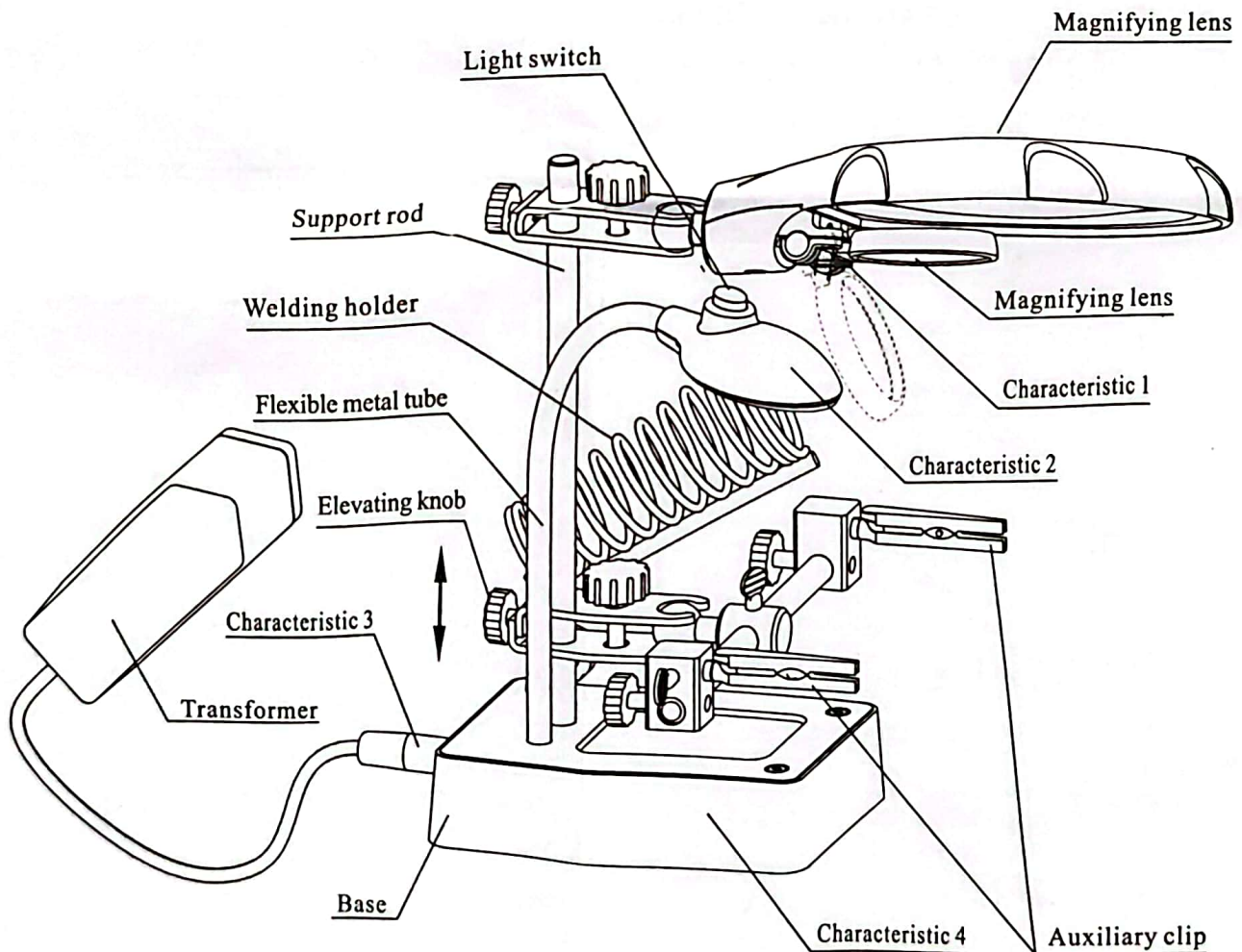

This product has been patented and copying is not permitted.
Patent application NO.:201230095315.0

Application range:

Electronic welding, modelling, stamp collecting, embroidery, antiques, biological observation, reading etc.

Characteristics:

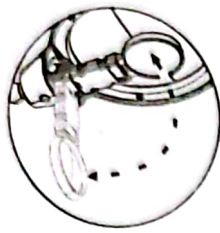

Adjust angle

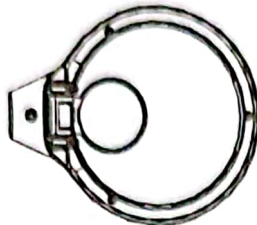

1st gear

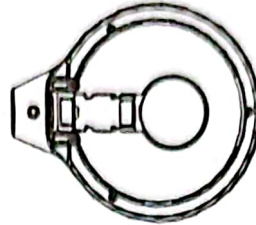

2nd gear

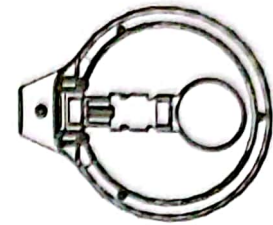

3rd gear

1. This product is installed with stretchable small lens, with choice of different magnifications during operation, making operation more comfortable. Three kinds of different stretchable gears are available to increase range of visual fields.

2. Independent 5LED lighting design makes magnifier and lighting device relatively independent. Distance and angle of lights can be adjusted freely. And this magnifier can be used separately as desk lamp.

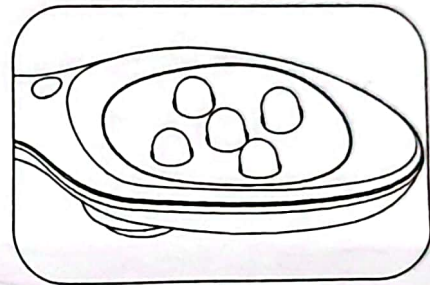

3. This product can use external power. When external power is used, built-in batteries will automatically disconnect. External power(input: AC100-250V, 50/60HZ, output: DC4.8V, 500mA)

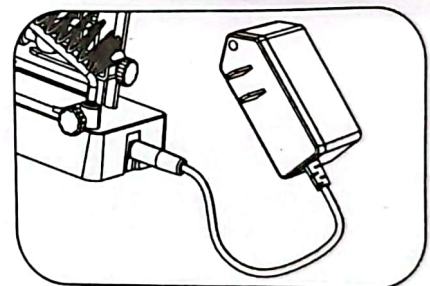

4. This product has three built-in AA batteries. Pull out the plug of external power if batteries are used for lighting.

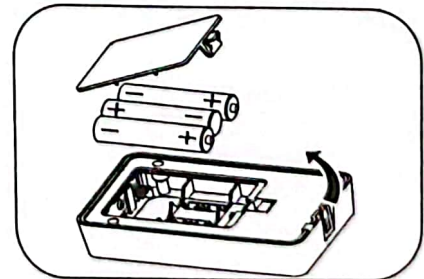

Warning: Using handtools can be dangerous. Always take care, and keep away from children, wear protective eyewear in work area at all times.

Select correct type and size of handtool for work.